

# Modular Command Post

[8340-01-459-8172 for the Camouflage Green #483 Class 1 System \(Fabric, frame, pins, poles and transport covers only\)](#)

[8340-01-323-2454 for the Camouflage Green #483 Class 1 System \(includes lights, tables, and mapboards\)](#)

[8340-01-459-8167 for the Desert Tan #459 Class 2 System \(Fabric, frame, pins, poles and transport covers only\)](#)

[8340-01-334-7528 for the Desert Tan #459 Class 2 System with Lights, Mapboards, and Tables](#)

**FEDMALL TEST LINK**

**[8340-01-459-\\*\\*\\*\\* COMMAND POST SYSTEM Tactical System FEDMALL Shopping List Link](#)**

The Modular Command Post System (MCPS) is a highly mobile, modular tent system that can be complexed into any configuration. The MCPS provides a highly functional shelter system that can be used for a variety of mission roles including Command Post and Tactical Operations Center, Administration, Billeting, Supply, Medical and Maintenance. The system is compatible with existing power generation, environmental control, and camouflage systems. The MCPS is lightweight and easy to transport, erect and strike.



The picture below shows the command posts interior featuring the light set, tables and mapboards.



## KEY FEATURES:

- Camouflage Green or Desert Tan coated polyester blackout fabric
- Erect time of 1 unit is accomplished by 2 soldiers in 20 minutes
- 121 square feet of uninterrupted floor space
- Total system weighs 257 pounds
- Flame resistant liner
- Compatible with optional boot kits allowing system to connect directly to track or wheeled vehicles
- Compatible with existing power generation, environmental control, and camouflage systems

## Description:

A single MCPS consists of telescoping support poles, and a lightweight three-piece aluminum alloy tubing frame, which supports coated polyester blackout fabric. The frame collapses to 96"Lx24" Wx7" H and stores in its own fabric carrying bag. The total system weighs 257



**pounds. An optional fabric boot kit allows the MCPS to connect directly to track and wheeled vehicles. The following boot kits are available for the MCPS:**

<b>NSN</b>	<b>Description</b>	<b>Application</b>
• 8340-01-364-4496	Camouflage Green, Type IV, Class I	Connects Command Post Tent to M1037, 250 Vehicle
• 8340-01-364-4497	Camouflage Green, Type II, Class I	Connects Command Post Tent to a Ridge Wall Shelter
• 8340-01-378-8301	Camouflage Green, Type I, Class I	Connects Command Post Tent to M577 Tracked Vehicle
• 8340-01-380-2241	Desert Tan, Type I, Class II	Connects Command Post Tent to M577 Tracked Vehicle

**The Technical Manual for this tent is TM-10-8340-222-10**

The picture below shows a MCPS with an S250 Shelter bootwall attached.



**PRODUCT SPECIFICATIONS:**

- Dimensions: 11'Length x 11'Width x 9'Ridge Height and 7'Eve Height
- Floor Area: 121 square feet
- Weight: 257 pounds
- Color: Camouflage Green or Desert Tan
- Set-up Time/# of Persons: 20/2
- Strike Time/# of Persons: 15/2
- Shipping Container Dimensions: 69x27x28
- Shipping Weight: 450 pounds

9. PLAIN WALL

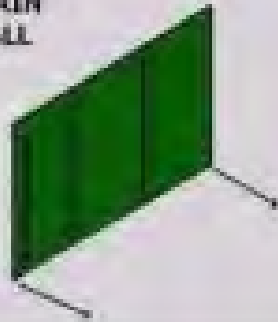

8. ROOF CAP



4. PLAIN WALL LINER



6. RAIN GUTTER  
(COMPLEX 2 COMMAND POSTS)

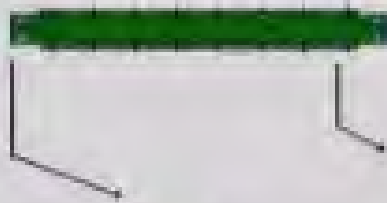

12. FRAME

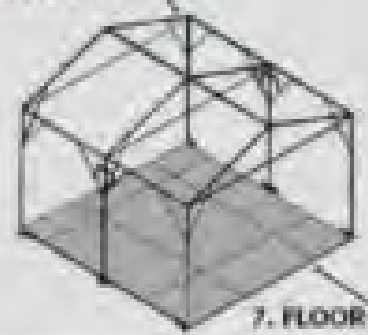

7. FLOOR

13. TELE-SCOPIC  
DOORWAY  
POLE

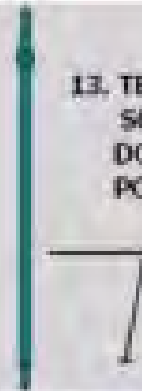

10. WINDOW  
WALL



5. ENTRANCE WAY AND  
WINDOW WALL LINER

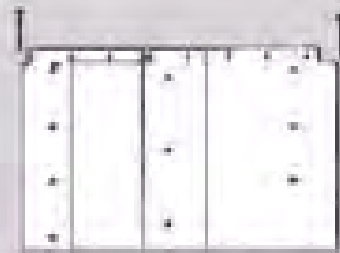

11. ENTRANCE  
WAY WALL

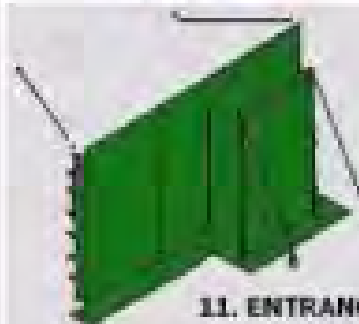

1. TABLE



3. LIGHT SET



2. MAPBOARD



15. FRAME TRANSPORT BAG



16.



17.



18.



19.



14. FABRIC TRANSPORT BAG



## MCP Green 8340-01-459-8172 includes the following:

NSN	Description	Quantity
<a href="#">8340-01-459-8172</a>	Camouflage Green #483	1

	NSN	DESCRIPTION	QUANTITY
1.	<a href="#">8340-01-333-0661</a>	PLAIN WALL LINER	1
2.	<a href="#">8340-01-331-3303</a>	ENTRANCE WAY/ WINDOW WALL LINER	3
3.	<a href="#">8340-01-331-0153</a>	GREEN RAIN GUTTER	1
4.	<a href="#">8340-01-331-3304</a>	FLOOR	1
5.	<a href="#">8340-01-331-5422</a>	GREEN ROOF CAP	1
6.	<a href="#">8340-01-333-4718</a>	GREEN PLAIN WALL	1
7.	<a href="#">8340-01-331-0152</a>	GREEN WINDOW WALL	2
8.	<a href="#">8340-01-331-3302</a>	GREEN ENTRANCE WAY WALL	1
9.	<a href="#">8340-01-334-2341</a>	FRAME ASSEMBLY	1
10.	<a href="#">8340-01-333-4126</a>	TELESCOPIC POLE	2
11.	<a href="#">8340-01-337-7234</a>	GREEN STORAGE/TRANSPORT BAG FOR FABRIC COMPONENTS	2
12.	<a href="#">8340-01-337-5561</a>	GREEN FRAME STORAGE/TRANSPORT BAG	1
13.	<a href="#">8340-00-823-7451</a>	PIN, STEEL, RED, 12 INCH	8
14.	<a href="#">8340-00-261-9751</a>	PIN, WOOD 24"	8
15.	<a href="#">8340-01-186-3030</a>	PIN STORAGE/TRANSPORT CONTAINER	1

## MCP Green with Tables, Mapboards and Lights includes the following:

NSN	Description	Quantity
8340-01-323-2454	Camouflage Green #483	1
NSN	DESCRIPTION	QUANTITY
1.	<a href="#">8340-01-333-0661</a> PLAIN WALL LINER	1
2.	<a href="#">8340-01-331-3303</a> ENTRANCE WAY/ WINDOW WALL LINER	3
3.	<a href="#">8340-01-331-0153</a> GREEN RAIN GUTTER	1
4.	<a href="#">8340-01-331-3304</a> FLOOR	1
5.	<a href="#">8340-01-331-5422</a> GREEN ROOF CAP	1
6.	<a href="#">8340-01-333-4718</a> GREEN PLAIN WALL	1
7.	<a href="#">8340-01-331-0152</a> GREEN WINDOW WALL	2
8.	<a href="#">8340-01-331-3302</a> GREEN ENTRANCE WAY WALL	1
9.	<a href="#">8340-01-334-2341</a> FRAME ASSEMBLY	1
10.	<a href="#">8340-01-333-4126</a> TELESCOPIC POLE	2
11.	<a href="#">8340-01-337-7234</a> GREEN STORAGE/TRANSPORT BAG FOR FABRIC COMPONENTS	2
12.	<a href="#">8340-01-337-5561</a> GREEN FRAME STORAGE/TRANSPORT BAG	1
13.	<a href="#">8340-00-823-7451</a> PIN, STEEL, RED, 12 INCH	8
14.	<a href="#">8340-00-261-9751</a> PIN, WOOD 24"	8
15.	<a href="#">8340-01-186-3030</a> PIN STORAGE/TRANSPORT CONTAINER	1
16.	<a href="#">5340-01-336-7034</a> SUPPORT STRAPS	10
17.	<a href="#">6230-01-465-8931</a> LIGHT SET (new 2 bulb,2 fixtures per set without storage case)	1
18.	<a href="#">8340-01-327-7685</a> TABLE	2
19.	<a href="#">8340-01-327-6124</a> MAPBOARD	4



## MCP Tan System includes the following:

NSN	Description	Quantity
8340-01-459-8167	Desert Tan #686	1

	NSN	DESCRIPTION	QUANTITY
1.	<a href="#">8340-01-333-0661</a>	PLAIN WALL LINER	1
2.	<a href="#">8340-01-331-3303</a>	ENTRANCE WAY/ WINDOW WALL LINER	3
3.	<a href="#">8340-01-337-5699</a>	TAN RAIN GUTTERS	1
4.	<a href="#">8340-01-331-3304</a>	FLOOR	1
5.	<a href="#">8340-01-337-5300</a>	TAN ROOF CAP	1
6.	<a href="#">8340-01-337-5297</a>	TAN PLAIN WALL	1
7.	<a href="#">8340-01-337-5298</a>	TAN WINDOW WALL	2
8.	<a href="#">8340-01-337-5299</a>	TAN ENTRANCE WAY WALL	1
9.	<a href="#">8340-01-334-2341</a>	FRAME ASSEMBLY	1
10.	<a href="#">8340-01-333-4126</a>	TELESCOPIC POLE	2
11.	<a href="#">8340-01-337-9215</a>	TAN STORAGE/TRANSPORT BAG FOR FABRIC COMPONENTS	2
12.	<a href="#">8340-01-336-9093</a>	TAN FRAME STORAGE/TRANSPORT BAG	1
13.	<a href="#">8340-00-823-7451</a>	PIN, STEEL, RED, 12 INCH	8
14.	<a href="#">8340-00-261-9751</a>	PIN, WOOD 24"	8
15.	<a href="#">8340-01-186-3030</a>	PIN STORAGE/TRANSPORT CONTAINER	1

# MCP Tan System with Tables, Mapboards and Lights includes the following:

NSN	Description	Quantity
8340-01-334-7528	Desert Tan #459 Class 2 System	1

	NSN	DESCRIPTION	QUANTITY
1.	<a href="#">8340-01-327-7685</a>	TABLE	2
2.	<a href="#">8340-01-327-6124</a>	MAPBOARD	4
3.	<a href="#">6230-01-465-8931</a>	LIGHT SET (new 2 bulb,2 fixtures per set without storage case)	1
4.	<a href="#">8340-01-333-0661</a>	PLAIN WALL LINER	1
5.	<a href="#">8340-01-331-3303</a>	ENTRANCE WAY/ WINDOW WALL LINER	3
6.	<a href="#">8340-01-337-5699</a>	TAN RAIN GUTTERS	1
7.	<a href="#">8340-01-331-3304</a>	FLOOR	1
8.	<a href="#">8340-01-337-5300</a>	TAN ROOF CAP	1
9.	<a href="#">8340-01-337-5297</a>	TAN PLAIN WALL	1
10.	<a href="#">8340-01-337-5298</a>	TAN WINDOW WALL	2
11.	<a href="#">8340-01-337-5299</a>	TAN ENTRANCE WAY WALL	1
12.	<a href="#">8340-01-334-2341</a>	FRAME ASSEMBLY	1
13.	<a href="#">8340-01-333-4126</a>	TELESCOPIC POLE	2
14.	<a href="#">8340-01-337-9215</a>	TAN STORAGE/TRANSPORT BAG FOR FABRIC COMPONENTS	2
15.	<a href="#">8340-01-336-9093</a>	TAN FRAME STORAGE/TRANSPORT BAG	1
16.	<a href="#">8340-00-823-7451</a>	PIN, STEEL, RED, 12 INCH	8
17.	<a href="#">8340-00-261-9751</a>	PIN, WOOD 24"	8
18.	<a href="#">8340-01-186-3030</a>	PIN STORAGE/TRANSPORT CONTAINER	1
19.	<a href="#">8340-01-336-7034</a>	SUPPORT STRAPS	10

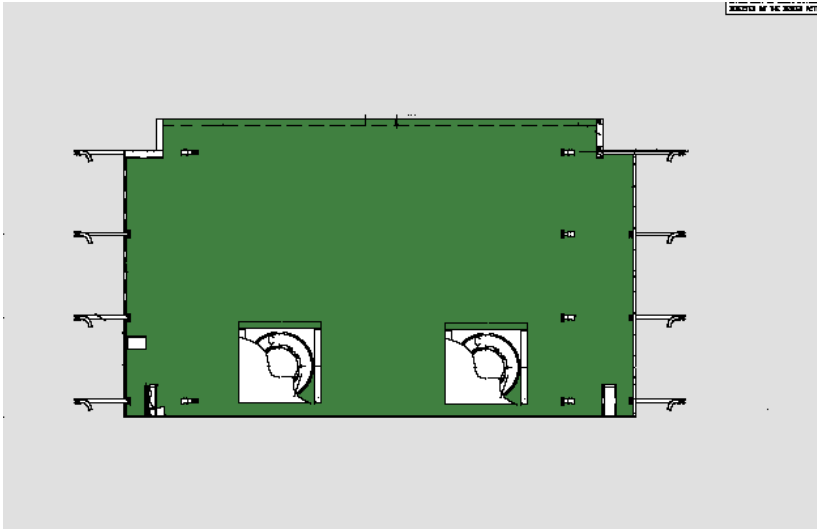

ECU Wall Assembly

The thermoelectric heater generates its own electrical power (approximately 200 watts) through the use of thermoelectric modules located in the combustion chamber. These modules convert waste heat into electrical energy, which is used to power the blowers, pumps, ignition system, safety system, and control devices required in the operation of the heater. The heater provides a 60% increase in combustion efficiency over currently fielded nonpowered heaters and provides much cleaner combustion of diesel fuel, translating to significantly reduced fuel costs and maintenance requirements.



The Space Heater Convective (SHC) is a 35K BTU thermoelectric heater that provides forced hot air circulation in military tentage without the need for an external power supply. This eliminates the need for a field generator. The SHC's intended applications include the Modular Command Post System, TOCs, and other tents housing expensive electronics equipment. The SHC is the first of its kind to successfully integrate thermoelectrics and combustion into a fieldable heater prototype that delivers clean, breathable heat to military tentage and shelters. 74 pounds



## Spare Parts & Options for the MCP:

NSN

DESCRIPTION



1. [8340-01-327-7685](#) TABLE
2. [8340-01-327-6124](#) MAPBOARD
3. [6230-01-465-8931](#) LIGHT SET  
(new 2 bulb,2 fixtures per set without storage case)
4. [8340-01-333-0661](#) PLAIN WALL LINER
5. [8340-01-331-3303](#) ENTRANCE WAY/ WINDOW WALL LINER
6. [8340-01-337-5699](#) TAN RAIN GUTTER
7. [8340-01-331-0153](#) GREEN RAIN GUTTER
8. [8340-01-331-3304](#) FLOOR
9. [8340-01-337-5300](#) TAN ROOF CAP
10. [8340-01-331-5422](#) GREEN ROOF CAP
11. [8340-01-337-5297](#) TAN PLAIN WALL
12. [8340-01-333-4718](#) GREEN PLAIN WALL
13. [8340-01-337-5298](#) TAN WINDOW WALL
14. [8340-01-331-0152](#) GREEN WINDOW WALL
15. [8340-01-337-5299](#) TAN ENTRANCE WAY WALL
16. [8340-01-331-3302](#) GREEN ENTRANCE WAY WALL
17. [8340-01-334-2341](#) FRAME ASSEMBLY
18. [8340-01-333-4126](#) TELESCOPIC POLE
19. [8340-01-337-9215](#) TAN STORAGE/TRANSPORT BAG FOR FABRIC COMPONENTS
20. [8340-01-337-7234](#) GREEN STORAGE/TRANSPORT BAG FOR FABRIC COMPONENTS
21. [8340-01-336-9093](#) TAN FRAME STORAGE/TRANSPORT BAG
22. [8340-01-337-5561](#) GREEN FRAME STORAGE/TRANSPORT BAG
23. [8340-00-823-7451](#) PIN, STEEL, RED, 12 INCH
24. [8340-00-261-9751](#) PIN, WOOD 24"
25. [8340-01-186-3030](#) PIN STORAGE/TRANSPORT CONTAINER
26. [8340-01-336-7034](#) SUPPORT STRAPS
27. [8340-01-380-2241](#) Bootwall Desert Tan, Type I, Class 2 (Connects the Command Post Tent to M577 Tracked Vehicle)
28. [8340-01-364-4496](#) Bootwall Camouflage Green, Type IV, Class1 (Connects the Command Post Tent to M1037, 250, Vehicle)
29. [8340-01-364-4497](#) Bootwall Camouflage Green, Type II, Class 1 (Connects the Command Post Tent to a Ridge Wall Shelter)
30. [8340-01-378-8301](#) Bootwall Camouflage Green, Type I, Class 1 (Connects the Command Post Tent to M577 Tracked Vehicle)
31. [4520-01-329-3451](#) Heater H-45 space heater  
(45000/btu/multifuel/solid fuel)
32. [4520-01-457-2790](#) Thermal Electric Fan

[4520-01-431-8927](#) Space Heater Convective

[8340-01-524-7884](#) ECU Wall Assembly